

## Double-walled Roller Shutter Door Profiles

Technical Specifications  
Accessories

ferdinand  
brasellmann.de

Diversity in profiles

# Double-walled Roller Shutter Door Profiles

# older Profiles

cross-sections, scale 1:1

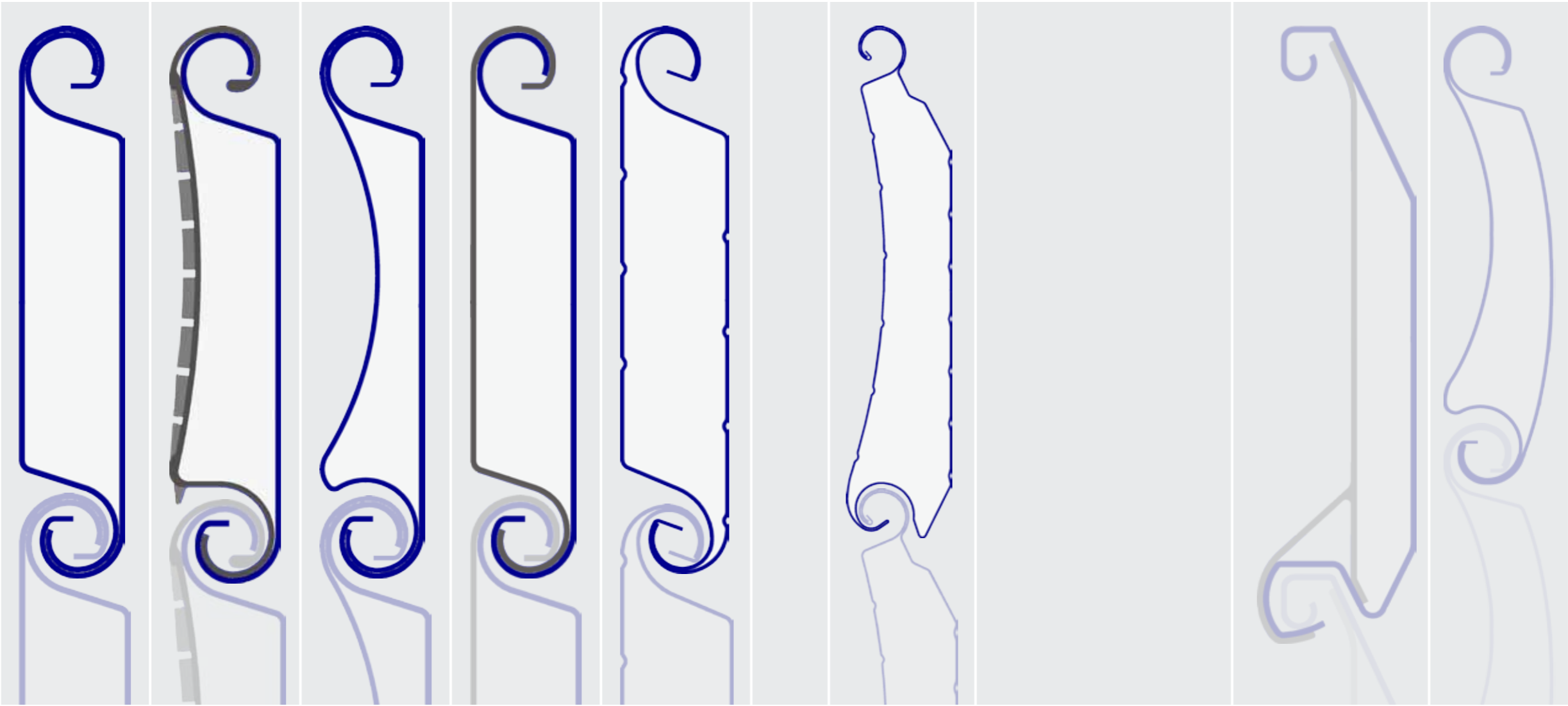

Profil-Nr.	1.100 D	ISO-SL	1.100 R	IsoPlus	1.D06	1.95 R
slats on 1 m height	10	10	10	10	10	10.1
thickness of slats [mm]	23	23	23	23	23	23
weight per m (m <sup>2</sup> ) at 1.0 mm	st. 28.6 kg al. 11.1 kg	al. 9.9 kg	st. 25.6 kg al. 9.8 kg	st. 18.0 kg al. 9.0 kg	al. (0.60) 6.8 kg	st. (0.38) 9.8 kg
smallest tube [mm]	159	159	133	159	159	133
fitting top- and bottom rails	1.1230   1.123 N   1.1278	1.1230   1.1278	1.1230   1.1278	1.1230   1.123 N   1.1278	1.1230   1.123 N   1.1278	1.1200   1.1295
galvanized steel max. door width <sup>2)</sup> [mm]	0.80 <sup>1)</sup>   1.00 <sup>1)</sup>   1.25 <sup>1)</sup>   1.50 <sup>1)</sup> 8500   9900   10700   11800	-	0.80/0.80   0.80/1.00 8400   9200	1.00   1.25 7400   8300	-	0.38 6500
aluminium max. door width <sup>2)</sup> [mm]	0.80 <sup>1)</sup>   1.00 <sup>1)</sup>   1.25 <sup>1)</sup>   1.50 <sup>1)</sup> 6100   6800   7800   8600	1.00   1.25 5500   6500	0.80/0.80   0.80/1.00 6200   6700	1.00   1.25 5500   6500	0.60 <sup>1)</sup> 5500	-
aluminium plastic coil coated	0.80   1.00   1.25	-	-	1.00   1.25	-	-
aluminium coil coated	1.00	1.00	-	1.00	-	-
stainless steel	0.80   1.00   1.25	-	-	1.00   1.25	-	-

1.1590 Iso	1.80 R
	steel profile, available on request (with appropriate quantities)

**Important information about the material types:**

st. = steel; hot-dip galvanized strip material  
 al. = ALMg2Mn0,8 normally; also available as anodized slats or for subsequent anodizing  
 ss. = stainless steel 1.4301 2B

Powder coating is available in all RAL colors according to the card RAL 840 HR.  
 The specified weights are calculated values at material thickness of 1.0 mm with polystyrene filling. Weight may vary according DIN.  
 Profile types 1.100 D and 1.D06 (see <sup>1)</sup> identifier) can be used for reverse coiling (must be specified when ordering).

Reinforcement angles and/or reinforcement brackets are recommended for high wind loads or large door widths.

<sup>1)</sup> Can be used as reverse coiling profile (for conditions see text on the right).  
<sup>2)</sup> The door widths specified here refer to roller shutter doors without storm hooks according to EN 12424 class 2 with rigid guide rails and only to our profiles. Values for wind class 3 on request.

## Top Rails

## Bottom Rails

## Sealing Lip Profiles

cross-sections, scale 1:1



matches  
1.95 R

matches  
1.100 D, ISO-SL,  
1.100 R, IsoPlus,  
1.D06

sealing lip 110 mm  
(EPDM)

available only in connection with complete roller shutters

profile	1.1200	1.1220	1.1230	1.123N	1.1278	1.1295
material thickness [mm]	1.0	1.25	1.5	1.5		
weight [kg/m]	st. 0.69	al. 0.33   st. 0.95   ss. 0.95	al. 0.41   st.1.2   ss. 1.2	al. 0.57   st. 1.62	al. 1.4	al. 0.88
matches profile type(s)	1.95 R	1.1590 Iso	1.100 D   ISO-SL 1.100 R   IsoPlus   1.D06	1.100 D   IsoPlus 1.D06	1.100 D   ISO-SL 1.100 R   IsoPlus   1.D06	1.95 R
stock lengths bright	9200 mm	6000 mm	6000 mm	6000 mm	9000 mm   12000 mm	9200 mm
stock lengths in E6EV1	-	6000 mm	6000 mm	6000 mm	9500mm   12000 mm	9200 mm

## Rubber Bottom Seals

M 1:2



1.1789\*

M 1:2



1.1791\*

M 1:3

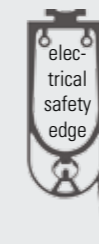

ASO\*

\*The rubber bottom seals 1.1789, 1.1791 and ASO made of EPDM can be combined with bottom rails 1.1278 and 1.1295

M 1:2



1.1793

The rubber bottom seal 1.1793 can in combination with profile type 1.95R be used without bottom rail.  
**With narrow door widths only!**



# Guide Rails

from **1)** galvanized steel **2)** extruded aluminium **3)** stainless steel

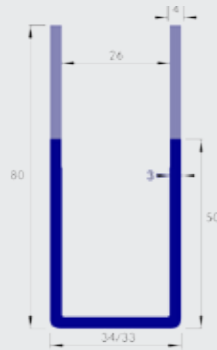

**1.1340 1) 3)**

dim.: 50 x 33 x 50 / 3.0 mm  
weight per meter: 3.0 kg  
stock length: 6200 mm

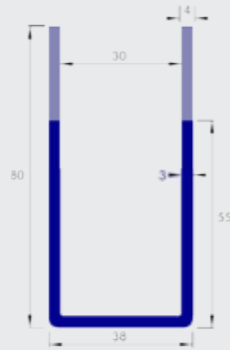

**1.1350 1) 3)**

dim.: 55 x 38 x 55 / 3.0 mm  
weight per meter: 3.25 kg  
stock length: 6200 mm

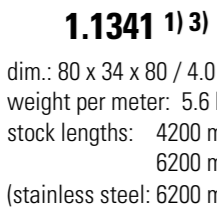

**1.1341 1) 3)**

dim.: 80 x 34 x 80 / 4.0 mm  
weight per meter: 5.6 kg  
stock lengths: 4200 mm  
6200 mm  
(stainless steel: 6200 mm)

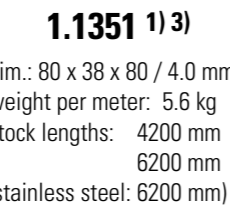

**1.1351 1) 3)**

dim.: 80 x 38 x 80 / 4.0 mm  
weight per meter: 5.6 kg  
stock lengths: 4200 mm  
6200 mm  
(stainless steel: 6200 mm)

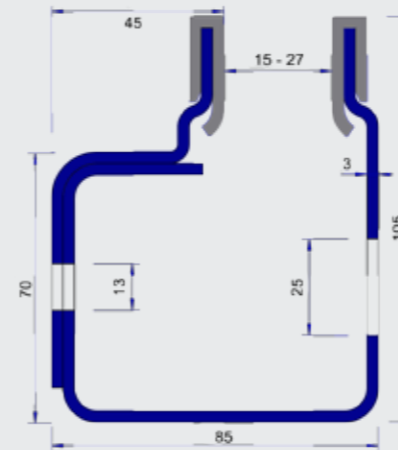

**1.1368 1)**

dim.: 105 x 85 x 105 / 3.0 mm  
weight per meter: 9.2 kg  
hole spacing: 600 mm  
stock length: 6000 mm

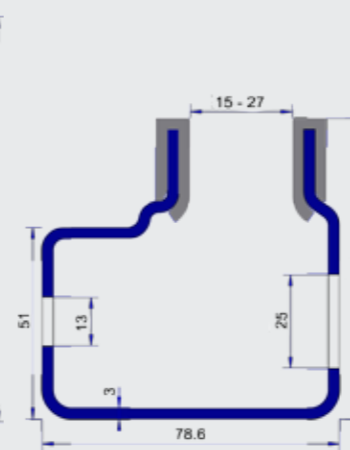

**1.1369 1)**

dim.: 80 x 78,60 x 80 / 3 mm  
weight per meter: 5.8 kg  
hole spacing: 600 mm  
stock lengths: 3600 mm,  
4200 mm | 4800 mm  
5400 mm | 6000 mm  
6600 mm

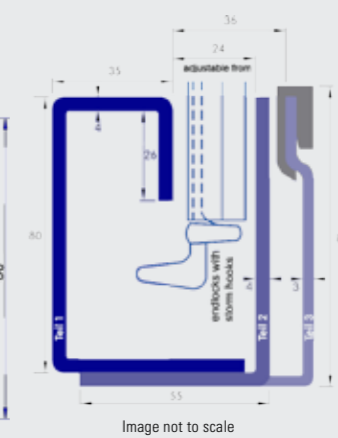

**1.1370 1)**

dim.: 80 x 55 x 80 x 35  
/ 4.0 / 3.0 mm  
weight per meter: 9.8 kg  
stock lengths: 4200 mm  
5200 mm | 6200 mm

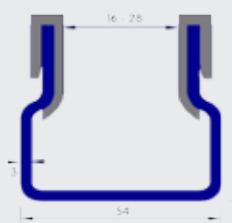

**1.1371-50 1)**

dim.: 50 x 54 x 50 / 3.0 mm  
weight per meter: 3.5 kg  
stock length: 6000 mm

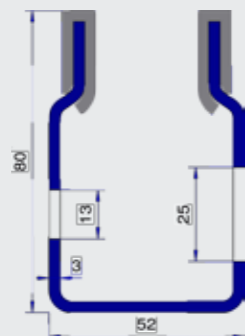

**1.1371-80 1) 3)**

dim.: 80 x 52 x 80 / 3.0 mm  
weight per meter: 4.7 kg  
hole spacing: 700 mm  
stock lengths: 3500 mm  
4000 mm | 4500 mm  
5000 mm | 6000 mm  
(stainless steel: 6000 mm)

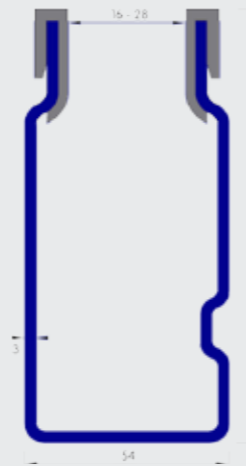

**1.1371-115 1)**

dim.: 115 x 54 x 115 / 3.0 mm  
weight per meter: 6.32 kg  
stock length: 6000 mm

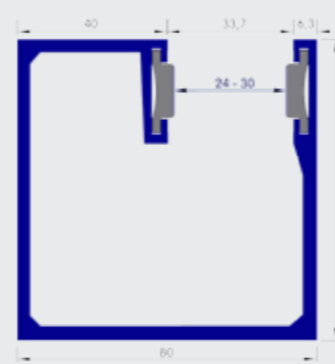

**1.1373 2)**

dim.: 80 x 80 x 80 x 40 mm  
weight per meter: 2.9 kg  
stock length: 6000 mm

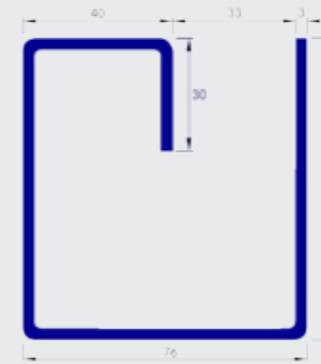

**1.1374 1)**

dim.: 80 x 76 x 80 x 40  
/ 3.0 mm  
weight per meter: 6.85 kg  
stock length: 5000 mm

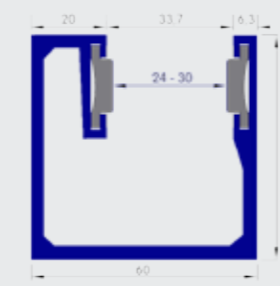

**1.1377 2)**

dim.: 60 x 60 x 60 x 20 mm  
weight per meter: 2.12 kg  
stock length: 6000 mm

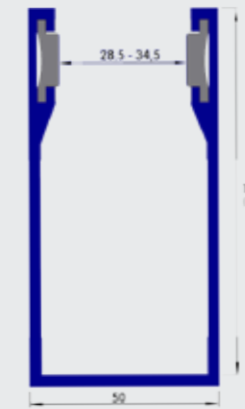

**1.1379 2)**

dim.: 70 x 50 x 70 mm  
100 x 50 x 100 mm  
weight per meter: 1.50 kg (70)  
1.95 kg (100)  
stock length: 6000 mm

# Accessories for Roller Shutter Door Profiles

Profil-Nr.		1.100 D									ISO-SL		1.100 R			IsoPlus		1.D06		1.95 R		
fitting endlocks																						
		plastic	plastic, without friction surfaces	Thermo	steel, galvanized	stainless steel	steel / aluminium	terror protection <sup>1)</sup>	storm hook	roller storm hook <sup>1)</sup>	plastic	storm hook	plastic	steel	storm hook	plastic	storm hook	plastic	storm hook	plastic	storm hook	
fitting guide rails	1.1340	-	-	-	-	-	●	-	-	-	-	-	-	-	-	-	-	-	-	-	-	
	1.1341	-	-	-	-	-	●	-	-	-	-	-	-	-	-	-	-	-	-	-	-	
	1.1350	●	-	●	●	●	●	-	-	-	-	-	-	-	●	-	●	-	-	-	-	
	1.1351	●	-	●	●	●	●	-	-	-	-	-	-	-	●	-	●	-	-	-	-	
	1.1368*	■	■	■	■	■	■	-	■	-	■	■	■	■	■	■	■	■	■	■	■	■
	1.1369*	■	■	■	■	■	■	-	■	-	■	■	■	■	■	■	■	■	■	■	■	■
	1.1370	●	●	●	●	●	●	-	●	-	-	-	-	-	●	●	●	-	●	●	-	
	1.1371*	■	■	■	■	■	■	-	-	-	■	-	■	■	-	■	-	■	-	■	-	
	1.1372*	■	■	■	■	■	■	-	-	-	■	-	■	■	-	■	-	■	-	■	-	
	1.1373*	■	■	■	■	■	■	-	-	-	■	-	■	■	-	■	-	■	-	■	-	
	1.1374	●	●	●	●	●	●	-	-	-	-	-	-	-	-	●	-	●	-	-	-	
	1.1377*	■	■	■	■	■	■	-	-	-	■	-	■	■	-	■	-	■	-	■	-	
	1.1379*	■	■	■	■	■	■	-	-	-	■	-	■	■	-	■	-	■	-	-	-	
fitting top rails	1.1200	-									-	-	-	-	-	-	-	-	●	-		
	1.1220	-									-	-	-	-	-	-	-	-	-	-	-	
	1.1230	●									●	●	●	●	●	●	●	●	●	-		
	1.123N	●									-	-	-	-	-	-	-	-	-	-		
fitting bottom rails	1.1278	●									●	●	●	●	●	●	●	●	-	-		
	1.1295	-									-	-	-	-	-	-	-	-	●	-		

\*with PVC in the combinations:  
 ■ = grey with grey  
 ■ = red with red  
 ■ = red with black  
 ■ = black with grey

<sup>1)</sup> Roller storm hooks and terror protection endlocks are used with special guide rails only.

## C-Profiles



### 2.7070 (1.1711)

dim.: 4.5 x 8 x 20 x 8 x 4.5  
 mat. thickness: 1.0 mm  
 weight per meter [kg]:  
 al. 0.1 | st. 0.32 | ss. 0.32  
 stock length: 6000 mm



### 2.7140

dim.: 9 x 23 x 32 x 23 x 9  
 mat. thickness: 2.50 mm  
 weight per meter: st. 1.63 kg  
 stock length: 6000 mm



### 2.7160

dim.: 6 x 32 x 52 x 32 x 16  
 mat. thickness: 3.0 mm  
 weight per meter: st. 3.09 kg  
 stock length: 6000 mm

cross-sections, scale 1:2

## Reinforcement Angles



### 1.1731

dim.: 40 x 60 / 3.0 mm  
 weight per meter: st. 2.3 kg  
 stock length: 6000 mm



### 1.1732

dim.: 55 x 85 / 4.0 mm  
 weight per meter: st. 4.2 kg  
 stock lengths: 4200 mm,  
 5200 mm, 6200 mm



### 1.1738

dim.: 40 x 60 / 3.0 mm  
 weight per meter: al. 1.1 kg  
 stock length: 6000 mm

cross-sections, scale 1:2

## Reinforcement Brackets for Guide Rail 1.1369

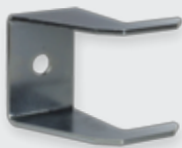

reinforcement bracket, small



reinforcement bracket, big

installation example

